

NORTH

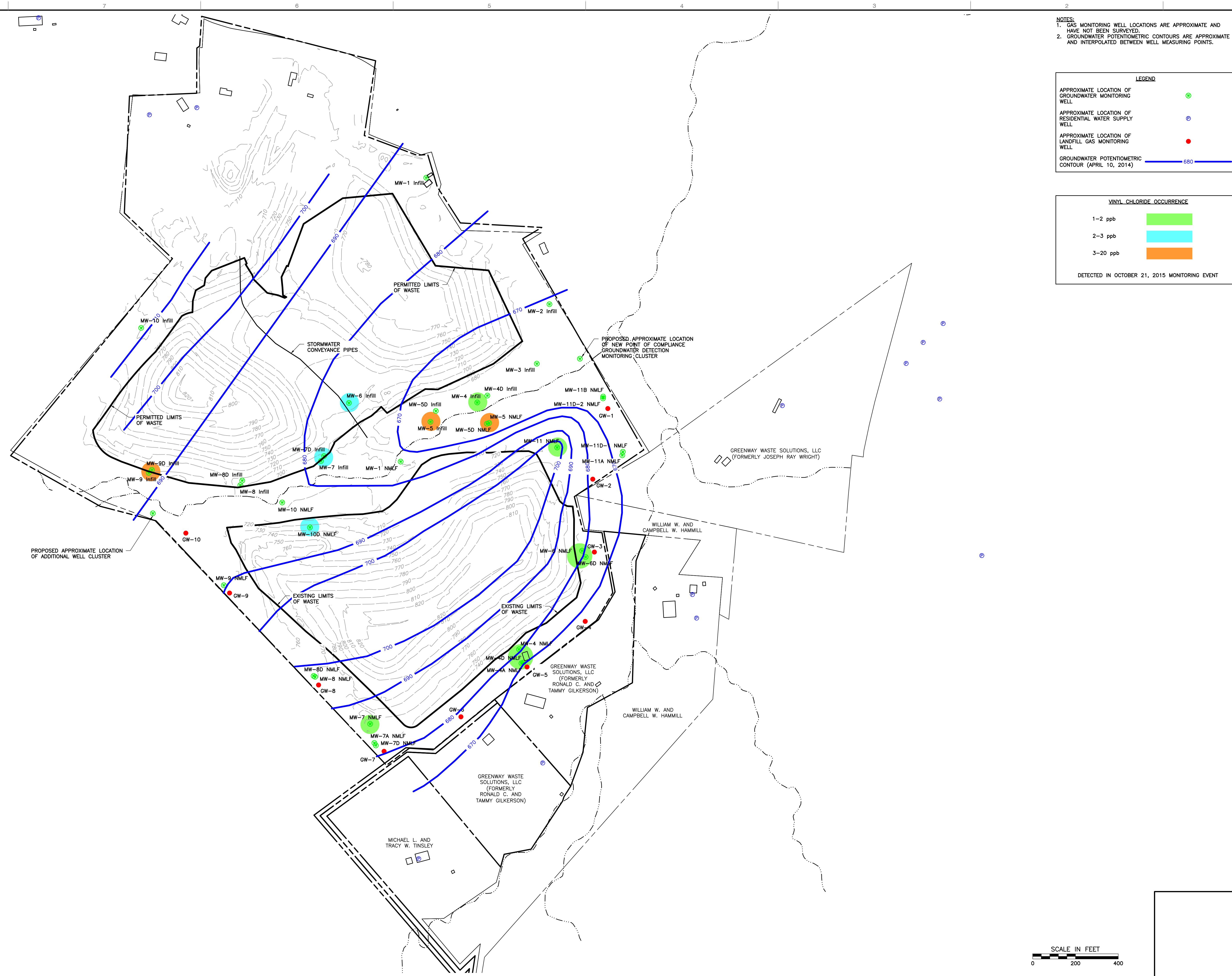

NOTES:
 1. GAS MONITORING WELL LOCATIONS ARE APPROXIMATE AND HAVE NOT BEEN SURVEYED.
 2. GROUNDWATER POTENTIOMETRIC CONTOURS ARE APPROXIMATE AND INTERPOLATED BETWEEN WELL MEASURING POINTS.

LEGEND

APPROXIMATE LOCATION OF GROUNDWATER MONITORING WELL	
APPROXIMATE LOCATION OF RESIDENTIAL WATER SUPPLY WELL	
APPROXIMATE LOCATION OF LANDFILL GAS MONITORING WELL	
GROUNDWATER POTENTIOMETRIC CONTOUR (APRIL 10, 2014)	

VINYL CHLORIDE OCCURRENCE

1-2 ppb	
2-3 ppb	
3-20 ppb	

DETECTED IN OCTOBER 21, 2015 MONITORING EVENT

REVISION RECORD

NO.	DATE	DESCRIPTION

Civil & Environmental Consultants, Inc.
 333 Baldwin Road · Pittsburgh, PA 15205
 412-429-2324 · 800-365-2324
 www.cetinc.com

**GREENWAY WASTE SOLUTIONS
 AT NORTH MECK, LLC
 NORTH MECK LANDFILL
 HUNTERSVILLE, NC**

SITE MAP

DATE:	MARCH 2016	DRAWN BY:	PNP
DWG SCALE:	1"=200'	CHECKED BY:	EHS
PROJECT NO.:	111-370-001	APPROVED BY:	EHS

FIGURE NO.: **2**

SHEET 1 OF 1

A:\2011\111-370\111-370-001\111-370-001_Groundwater Map for Ecology\24 X 36 US\2/2/2016 - preliminary - LP_3/2/2016 8:14 AM