

CURVE	RADIUS	ARC LENGTH	CHORD LENGTH	CHORD BEARING	DELTA ANGLE	TANGENT
C1	220.00'	305.81'	281.78'	N 31°53'24" E	79°38'41"	183.44'
C2	20.00'	34.93'	30.66'	S 58°15'08" E	100°04'52"	23.87'
C3	10748.16'	313.52'	313.51'	S 09°03'06" E	01°40'17"	156.77'

CALDWELL CREEK DR.
(60' R/W)

STATESVILLE RD./
US HWY . 21

GENERAL NOTES

Subject Property is not located within 100 yr Flood Plain (Zone X) according to Federal Emergency Management Agency, Flood Insurance Rate Map 3710464200 with an effective date of March 2, 2009.

Elevations based on GPS Observation using CORS Stations "CONCORD CORS", "GASTON CORS", and "MOORESVILLE CORS", Vertical Datum NAVD 88.

Contact proper Authorities Before building near utility lines, for easement width and restrictions. Utilities are approximate and should be verified prior to any construction.

This survey has been prepared for the exclusive use of the person or entities named hereon. No express or implied warranties with respect to the information shown hereon is to be extended to any persons or entities other than those shown hereon.

A Topcon Hiper RTK GPS unit was used to collect boundary control. A Topcon 802A was used to collect boundary data from set control. Boundary control points were collected and rechecked on two separate days. The positional tolerance was within 0.07' and was not adjusted.

Areas calculated by coordinate method.

Property Zoned B2

Setbacks need to be verified by Site Engineer.

I, Michael S. Perdue certify that this plot was drawn under my supervision from an actual survey made under my supervision and is a Tract # in DB, 11056 pg. 1785, that the ratio of precision as calculated 1:20,000 +/- and was not adjusted, that this plot was prepared in accordance with G.S. 47-30 as amended. Witness my original signature, registration # and seal this 1st day of Sept. 2010.

That this survey is of an existing parcel of land, existing structures and buildings and does not create a new street or change existing streets.

Michael S. Perdue, PLS# L-4322

SURVEY REFERENCE:

1) PB. 34, pg. 715

LEGEND

STANDARD ABBREVIATIONS

CB CATCH BASIN
CI CAST IRON
CMP CORRUGATED METAL PIPE
CMF CONCRETE MONUMENT FND
CT CRIMPED TOP PIPE
DI DROP INLET
FNC FENCE
FND FOUND
G GAS
GALV GALVANIZED
IE INVERT ELEVATION
JB JUNCTION BOX
MH MANHOLE
OT OPEN TOP PIPE
POB POINT OF BEGINNING
RB IRON REINFORCING BAR
RCP REINFORCED CONCRETE PIPE
SS SANITARY SEWER
TEMP TEMPORARY
W WATER
OHP OVERHEAD POWER
IPF IRON PIN FOUND
IPS IRON PIN SET
PT POINT

STANDARD SYMBOLS

POWER POLE
WATER VALVE
SANITARY SEWER MANHOLE
STORM SEWER MANHOLE
FIRE HYDRANT
SPOT ELEVATION
GUY WIRE
GAS LINE
WATER LINE
POWER LINE
UNDERGROUND POWER LINE
UNDERGROUND PHONE LINE
TRAFFIC FLOW ARROW
LIGHT POLE
CONCRETE MONUMENT
GAS VALVE
FORCE MAIN

GRAPHIC SCALE

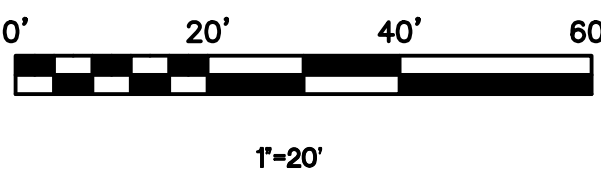

PLEASE NOTE

INFORMATION REGARDING THE PRESENCE, SIZE AND LOCATION OF UNDERGROUND UTILITIES IS SHOWN HEREON. THIS INFORMATION HAS BEEN SHOWN BASED ON THE LOCATION OF ABOVE GROUND APPURTENANCES, AVAILABLE DESIGN PLANS AND FLAGS AND PAINT PLACED BY THE UNDERGROUND PROTECTION SERVICE. NO CERTIFICATION IS MADE AS TO THE ACCURACY OF THOROUGHNESS OF THE INFORMATION CONCERNING UNDERGROUND UTILITIES AND STRUCTURES SHOWN HEREON. PER GEORGIA LAW, THE UNDERGROUND UTILITIES PROTECTION SERVICE MUST BE CALLED PRIOR TO THE COMMENCEMENT OF ANY AND ALL EARTH DISTURBING ACTIVITIES.

CAUTION

NORTH CAROLINA UTILITIES PROTECTION CENTER

3 DAYS BEFORE DIGGING CALL
TOLL FREE 1-800-632-4949

A ONE CALL SYSTEM FOR COMMUNITY AND JOB SAFETY.



5200 Buffington Rd.
Atlanta Georgia,
30349-2998

Revisions:

Mark Date By



Mark Date By



Mark Date By



Seal

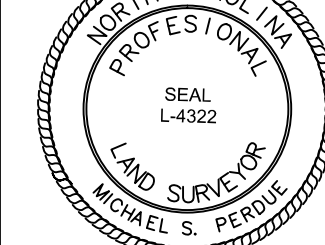

MICHAEL S. PERDUE, PLS # L-4322



STORE

SHEET TITLE

ASBUILT
SURVEY

DWG EDITION 04.6

☐ Preliminary
☐ 80% Submittal
☐ For Construction

Job No. : _____

Store : _____

Date : _____

Drawn By : _____

Checked By: _____

Sheet

C-1.1

ASBUILT SURVEY FOR



CITY: HUNTERSVILLE

COUNTY: MECKLENBURG

STATE: NORTH CAROLINA

DATE OF SURVEY: 6/29/12

SCALE: 1:20

FIELD WORK: MSP

DRAWN BY: MSP

REVIEWED BY: MSP

MSP FILE:CAHUNT

MSP JOB# :12688